

Scoil Fhionáin

An Fál Carrach

www.scoilfhionain.ie

scoilfhionain.anfalcarrach@gmail.com

074-9135122



Maidin scoile/Arrival at school Dé Céadaoin 26ú Lúnasa/26th August 9.10-9.30

- Tabhair do pháiste go geata na scoile ag an am ceart . Cuirfear fáilte roimh gach dalta scoile/ **All children should aim to arrive at the school no earlier than 10 minutes past nine . Children will be welcomed by principal, teachers and SNAs and shown direction to class.**
- **When children arrive at school, between 9.10 and 9.30 am, they will go straight to their class. Staff members will be there to guide them in direction of class. 2nd and 6th class will use the upper entrance, i.e, near office. 3, 4 and 5 will use main entrance.** Special consideration will be given to infants and their parents/guardians of course, to allow for first day at school experience. The infant play area will be used for this purpose, to allow parents to reassure children on first days.

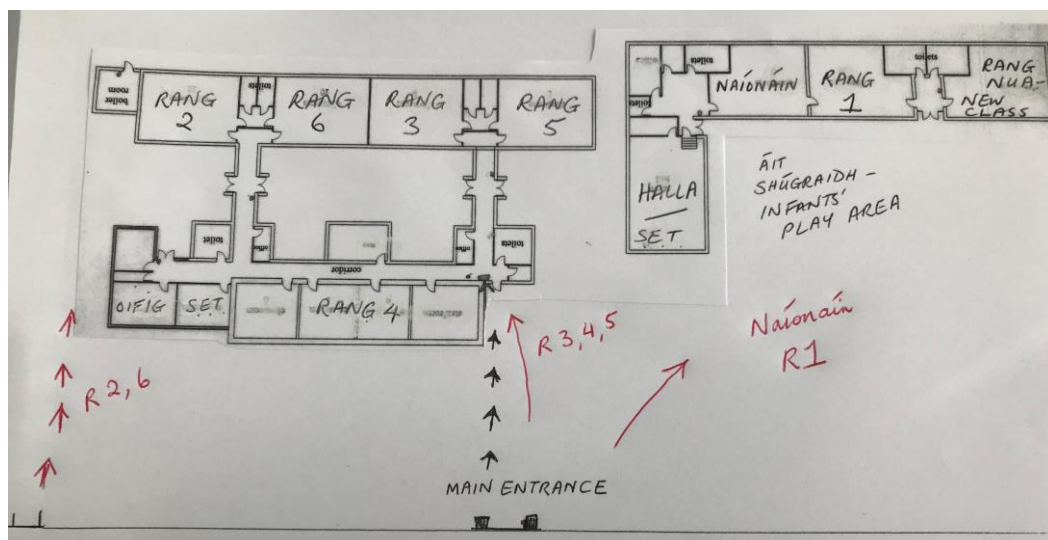

- Le do thoil, gan a bheith ag fanacht thart taobh amuigh de gheataí na scoile. We ask for co-operation with these times as it will mean that the numbers congregating on school grounds at any one time will be minimised.
- **Níl cead ag daoine fásta teacht isteach 'na scoile gan cead . No adults**, other than staff members, should enter the building. Access to the school is through appointment only, by ringing 074-9135122
- **ALL VISTORS INCLUDING PARENTS/GUARDIANS -Yellow "Footsteps" symbols in yard will guide parents/guardians/visitors to the main entrance. Parents/guardians of infants may use infant entrance, after phoning school.**
- **Ag an bpríomhdhoras/ At the main school entrance will be a contact tracing sheet to sign. Please exit school by office "oifig" exit.**
- Ta cruinnithe leis na múinteoiri tábhachtach agus déanfaimid ar ndícheall seo a eagrú tríd na bliana. Meeting with teachers are as important to your child's learning as ever before and we will make these arrangements with you *on a case by case basis*.

Le Linn an Lae/During the Day

- **Breaks and lunches are "staggered"- with two breaks and two lunchtimes organised to facilitate better social distancing and adherence to Bubbles.**
Each class is a "bubble" and the bubble is broken down further into pods, with small numbers of children in each pod. As per DES guidelines, schools must use all available space in classroom to maintain social distancing.
- **With good hand hygiene and good cough etiquette, we will go a long way to preventing an outbreak.**
- **Éide Scoile/School Uniform- mar is gnáth/as usual uniform is worn.**

Fearais Pearsanta/ Personal Equipment

- Táimid ag iarraidh ar gach duine a fearais ranga fein a thabhairt ar scoil- pinn luaidhe, cás phinn luaidhe, criáin & rl agus gan iad a roinnt. Caithfidh siad iad a fhágáil sa rang.
We request that children will have their own pens, pencils, colours, etc., to school in their own pencil case to avoid the sharing of equipment. These will remain at school and not be shared.
- **Obair Bhaile:** Don chéad thréimhse scoile tá an béim curtha uilig ar pháistí agus foireann a thabhairt isteach go sábháilte . Ní bheidh siad ag roinnt ábhair scoile cosúil le pinn, leabhair etc.

Homework and schoolwork: Our primary focus is the safe return for staff and children. Priority will be given to reassuring pupils and being hopeful in our conversations with them. A list of copies has been published on **“Ar ais ar scoil” section of www.scoilfhionain.ie for children in 3rd-6th class.** We will only be giving unwritten homework for the next while, in line with current best practice in Donegal schools. Teachers are moving towards the use of the SEESAW app which will be explained to children as an online learning platform.

De réir a chéile/Gradually teachers may send home one or two books to work with at home ag Maths & Spellings workbooks, readers, library books. We will adhere to the 72 hr advice while maintaining common sense.

Lón Scoile/ School Lunches;-

Táimid ag iarraidh ar thuismitheoirí/caomhnóirí lón follain a chur na scoile gach lá go dtí go bhfuil an córas úr socraithe againn don scoilbhliain. Níl cead bruascar ar scoil mar seacláid, milseáin & rl.

We ask parents and guardians to **send a healthy lunch to school** every day until we get the local lunches sorted. Cope and Centra as before. **We have a healthy lunch policy and therefore bringing in chocolate, biscuits and treats such as crisps is not allowed.**

Dílghalrú lámha/Hand Sanitising

New hand sanitisers (automatic) have been installed at all entrances and classrooms, as well as extra soap dispensers, paper towels and sanitising wipes- These are all freely available to all pupils and staff, and will there will be specific training for all on our return to school.

Ag Roinnt Fearais/Shared Equipment

Bíonn orainn fearais a roinnt in amanna mar ríomhairí, cluichí I ghníomhachtaí Aistear & rl. Glantar na fearais seo chomh minic agus is féidir.

By necessity, some classroom equipment needs to be shared including tablets, laptops and the equipment used for structured activities and play in Infant classrooms. Cleaning of such shared equipment with wipes or other cleaning products will take place at regular intervals to minimise the risk of the spread of infection.

Glanadh na Scoile/Cleaning ;

Méadófar na hámana glanadh sa scoil gach lá. Beidh múinteoirí/CRS ag glanadh na táblaí sa scoil i rith an lae agus beidh na seomraí uilig glanta ag an airíoch/glantóir sa trathnóna.

School cleaning hours have been increased significantly , with work ongoing throughout the summer to ensure a clean environment for all. All classrooms will be sanitised twice a day, once by teacher/SNA and in afternoons by caretaker/cleaner, with fogging throughout once a week (Aquagenic Fogging co.)

Specific training has been made available to ensure proper cleaning procedures.

Ag Dul Abhaile/End of School Day 12.30pm for new infants for first weeks, until 11th September, then 2pm/3pm for Rang 1-6

- Ag deireadh an lae rachaidh rang amháin amach in ord Rang 3, 4 agus 5, Rang 2 agus 6, agus rachaidh Rang 1, Rang Nua amach le chéile, agus baileoidh na tuismitheoirí/caomhnóirí iad ansin, nó siúlfaidh siad amach an gheata ina aonair. When the school day for that class is over the following arrangements will apply – Classes will leave the school separately and in order, to minimise contact. 3rd, 4th, and 5th in that order, 2nd and 6th in that order, other classes as normal.
- They will be brought to the front of the school. Children and adults must disperse as quickly as possible. If your child travels to school independently – please remind them that they must travel away from the front of the school as quickly as possible. If a child is usually collected and the person who collects them has not arrived, they must return to school and the teacher will bring any child who has not been collected back to the oifig. Please remind your children to come back to the oifig if they are not collected by the usual person. You must remind them NOT TO GO with anyone else.
- Please use church car park where possible.

Bailiú na Páistí i rith an lae/Collection of Children during the School Day

Ma ta tuismitheoir/caomhnóir ag bailiú páiste i rith an lae caithfidh siad;

If an adult has to collect a child during the course of the school day, the following arrangements will apply

- Cuir glaoch ar an oifig / When the adult arrives at the school, they should either phone the office or have made prior contact with teacher.
- Tabharfaidh duine den fhoireann an páiste go dtí an geata scoile. The child will be brought from his/her class to the adult by a member of staff.
- Beidh ar an tuismitheoir/caomhnóir an páiste a shíniú amach. The adult who is collecting will be asked to sign the child out.
- Na tar isteach san fhoirgneamh gan cead. No adult should enter the school building, unless invited to do so.



Ag plé le cás Covid 19 / Dealing with a suspected case of Covid-19

- Ní chóir do pháiste teacht ar scoil má tá aon comharthaí Covid orthu. Leanfaimid na céimeanna seo má léiríonn siad na comharthaí;-

Pupils should not attend school if displaying any symptoms of Covid-19. If a pupil displays symptoms of Covid-19 while in the building, the following are the procedures will be implemented:

- Cuirfear glaoch ar na tuismitheoirí /caomhnoirí laithreach.
Parents/guardians will be contacted immediately. Child will be reassured that all will be well, as is normal practice in Scoil Fhionain in the event of illness at school.
- Rachaidh ball den fhoireann go dtí an seomra in aice na h-oifige .Coinneoidh an ball foirne 2 mheadair ón pháiste.
The child will be accompanied to the **designated isolation area**. The staff member will remain at least 2 metres away, while of course resassuring child that we just have to be careful. The room has been decorated in such a way as to offer an atmosphere of calm.
- Tabharfar masc don pháiste agus ba chóir don pháiste é a chaitheamh.
A mask will be provided for the child presenting with symptoms. She/ He should wear the mask while exiting the premises.
- Good practice re respiratory etiquette and hand hygiene will be reinforced by member of staff during this time.
- Is feidir an páiste a chur abhaile le ball den chlann chomh luath agus is féidir agus é/í a thabhairt go dtí an dochtúir.
If the child is well enough to go home, the school will arrange for them to be transported home by a family member, as soon as possible, and advise them to inform their GP by phone of their symptoms. Public transport of any kind should not be used.
- Má tá siad ró thinn le dul abhaile cuirfear glaoch ar na h-uimhreacha cuí agus an chomhairle sin a leanúint.
If they are too unwell to go home or advice is required, the school will contact 999 or 112 and inform them that the sick child is a Covid-19 suspect.
- Beidh gá an seomra a ghlanadh láithreach.
Arrangements will be made for appropriate cleaning of the isolation area and work areas involved.

Cuirfidh an HSE eolas ar dhuine- tuismitheoir/ball foirne & riar an eolas tríd ‘contact tracing’ . Leanfar comhairle an HSE. The HSE will contact all relevant persons where a diagnosis of COVID-19 is made. The instructions of the HSE should be followed.

Ná cur páiste ar scoil má;

Children who should not attend school

- Páiste le Covid 19
Children who have been diagnosed with Covid-19
- Páistí i dteagmháil le duine ar bith leis an tinneas.
Children who have been in close contact with a person who has been diagnosed with Covid-19
- Paistí ag fanacht ar toradh scrúdú
Children who have a suspected case of Covid-19 and the outcome of the test is pending
- Paistí i dteagmháil le duine ag fanacht ar scrúdu.
Children who have been in contact with a person who has a suspected case of Covid-19 and the outcome of the test is pending

- Páistí le droch shláinte le comhairle ón dochtúir fanacht sa bhaile.
Children with underlying health conditions who have been directed by a medical professional not to attend school
- Paistí ag teacht abhaile ó saoire thar lear , ar feadh 14 la.
Children who have returned home after travelling abroad and must self-isolate for a period of 14 days
- **Páistí nach mothaíonn go maith.**
Children who are generally unwell, with colds or sore throats etc- this must be checked out.

Ag tacú le páisti atá sa bhaile/ Supporting the Learning of Children who cannot attend school

Muna bhfuil páiste in ann freastal ar scoil ar feadh tamaill déanfaidh an scoil iarracht gníomhachtaí, ceachtanna a thabhairt don pháiste le déanamh sa bhaile.

If a child is not able to attend school for an extended period of time, the class teacher (and/or the learning support teacher, where relevant) will provide suggested activities to support the child's learning at home will be shared with parents.



Má ta Covid sa rang/Impact of a Suspected or Confirmed Case of Covid-19 in a Class

Má ta fhios ag an scoil go bhfuil Covid 19 sa rang ;

If the school is notified that a person in your child's class has a suspected or confirmed case of Covid-19;

- Cuirfear eolas chuig na tuismitheoirí/caomhnóirí , le comhairle ón HSE.
The parents of all children in the class will be notified upon advice from the Public Health officials
- Leanfar comhairle ón HSE.
Public health advice will be sought and followed

Tacaíocht Foghlama/ Learning Support

Mar chuid den Thacaíocht Foghlama beidh meascán de Múinteoireracht Foirne agus múinteoireacht ghrúpa. Beidh na múinteoirí TF ag obair lastigh de na bholgain.

In keeping with our Special Education policy, learning support will be provided by a blended approach of in-class support and withdrawal. The provision of support will be organised to ensure our support teachers will work within the confines of a bubble.

- Coinneoidh an Múinteoir TF fad ón mhuinteoir ranga.
Where a support teacher is working alongside a class teacher in a classroom, both teachers must be mindful of maintaining social distance from one another.
- Má tá páistí ag fail múinteoireacht bhreise taobh amuigh den rang leis an Muinteoir TF , coinneofar fad 1 mheadar óna cheile.
Where children receive support in any room, social distancing of 1 metre will be maintained between each child in the group.
Glanfar na boird agus cathaoireacha idir gach ghrúpa.
- The tables and chairs in SET rooms will be wiped clean in between different groups attending.

PPE

Ní gá don fhoireann PPE a chaiteamh, ach amhain nuair nach bhfuil siad in ann 2 mheadair a choinneáil o na daltaí m.sh. ag tabhairt cuidiu do pháiste tar éis timpiste, ag suí in aice le páiste ag leamh & rl.

Beidh gach duine ciallmhar.

While it is not envisaged that PPE will be worn by staff in general, staff who are attending to particular care needs or who are administering first aid will wear appropriate PPE including gloves and face masks. Masks or visors must be worn when a staff member cannot keep a 2 metre distance from the students indoors .

Mask and visors are being made available for all staff.

It is not advised that primary school children wear masks to school, but needless to say we will adopt an understanding approach if parents/guardians are

Múinteoirí as láthair/Teacher Absence and Substitution

Má tá múinteoir as láthair, gheobhaidh muid ionadaí ón App áitiúil. Leanfaidh na múinteoirí na treoracha céanna ó thaobh comharthaí tinnis & rl.

In the event that teacher is unable to attend school, there is a support panel App being developed to make available substitute teachers; otherwise school will make arrangements from support teachers and principal availability in school.



Corpoideachas &

Sport/ PE

Beidh Corpoideachas ar siúl amuigh faoin aer chomh fada agus is féidir agus bainfimid an mhéid úsáide as an pháirc agus is féidir.

Glanfar an hall tríd an lae- binsí & rl.

Where possible, PE will take place outdoors and use of equipment should be confined to the sets that have been distributed to class groupings. If the PE hall is being used by class groupings, common touch points should be cleaned at intervals throughout the school day. We will use the pitch where possible.

Cursaí Breise/ Extra-curricular Activities

Táimid an bhróduil as na gníomhachtaí ar fad a bhíonn ar siúl anseo agus déanfaimid ár ndícheall gníomhachtaí breise a chur ar siúl ach caithfidh gach rang bheith ina aonair tríd an lae.

We are very proud of all the activities we have built up over the years (music lessons , Gaelic training, chess and coding, Reading Rooms) and the possibility of facilitating extra-curricular activities will be explored. However, it would not be recommended that children from different bubbles would participate in extra-curricular activities at the same time. Further updates will be provided in September.

B'fhéidir go mbeidh orainn rudai a athru am go h-am, ag brath ar coinníollacha agus treoracha ón Roinn Oideachais, an HSE agus an Patrún, an tEaspag Mc Guckian.

Coinneoimid sibh ar an eolas i gcónaí.

We may have to adjust or change things as we go along, in line with ongoing direction and advice from the HSE, Department of Education and our patron body, Bishop of Diocese of Raphoe. Information has yet to come from Bus Éireann re school transport protocols.

We will pass on all relevant information at all times to parents and guardians.

In the meantime, please reassure your child(ren) that we are doing everything we can to ensure their safe return to school. The Return to School advice tells us that it is important to give children hope.

Le cuidiú Dé, beidh achán rud i gceart.

Tá pictiúirí an chéad chomaoineach/First Holy Communion pictures ar www.scoilfhionain.ie
Go raibh maith agat Múnteoir Patricia agus Fr. James.

Ag súil le bliain dheas shuaimhneach- looking forward to the school year .

21 Lúnasa 2020

